



Product Name	GAOTek Tracker Locator Bluetooth Beacon - 10 years battery life
Product SKU	GAOTek-BB-122
Product URL	https://gaotek.com/product/gaotek-tracker-locator-bluetooth-beacon/

P2 Long Range Beacon 10 Years Battery



10 years battery life

900m(2952ft)





Contents

PRODUCT FEATURE	4
HOW IT WORKS:.....	4
USAGE SCENARIOS:.....	5
BASIC SPECIFICATIONS.....	7
TECHNICAL SPECIFICATIONS	8
BROADCAST SPECIFICATIONS	9
COMPATIBILITY	10
BASIC OPERATION.....	10
1. Hanger installation.....	10
2. Double-sided Tape.....	11
PRECAUTIONS	12
QUALITY ASSURANCE.....	12

PRODUCT FEATURE



- Ultra long range 900m(2952ft)
- IP67 waterproof
- Supports coded PHY long range.
- Large capacity battery(5200mAH)
- Easy to replace the battery.
- Support bracket installation and 3M stickers.
- 8dBm TX power

P2 Beacon is a portable Beacon with ultra-low power chipset nRF52 series and BLE 5.0 technology. P2 Beacon has a battery life of over 10 years. It has an IP67 waterproof rating and provides a Bluetooth range of up to 900m(2952ft), designed for asset tracking and indoor location services. P2 is easy to install using included 3M stickers or bracket mounts.

HOW IT WORKS:

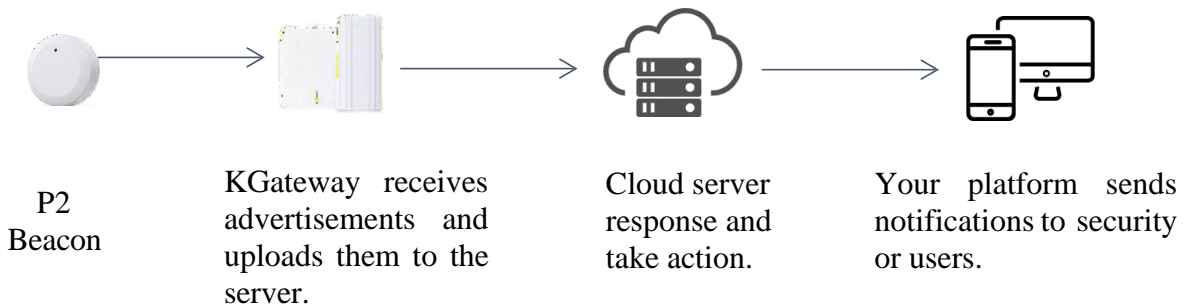

USAGE SCENARIOS:

Indoor Navigation



- Proximity marketing.
- Route planning & optimization
- Push Notification

Location Tracking



- Personnel positioning
- Location info collecting
- Data record

BASIC SPECIFICATIONS

Size	Dia 74mm*24mm Dia 74mm*28mm(with bracket)
Material	ABS
Color	White (Other colors can be customized) Default: 2 * ER14505 battery
Weight	98g (no bracket) 108g (with bracket)
Battery capacity	5200mAh(replaceable) Optional: 2 * AA battery 2200mAh (replaceable)
Battery life	10 years [1]
Waterproof	IP67
Working temperature	-40°C ~+85°C
Working humidity	0 ~ 99% RH
Button	1 Button (internal)
LED	1 LED
Sensor	Accelerometer
Configure APP	KBeaconPro

* [1] Based on a Broadcast Interval of 200 milliseconds and TX power of 0 dBm

TECHNICAL SPECIFICATIONS

Chip	Nordic nRF52 Series
Bluetooth version	BLE 5.0(compatible with BLE 4.x)
TX power	-40dBm ~ +8 dBm
Transmit range	· Normal:250m(820ft) · Coded PHY:900m(2952ft)
Broadcast interval	100 ms ~ 40000 ms
OTA	YES
Accelerometer	Range: +/-2 g, can be adjustable by firmware Measure accuracy: +/-32 mg

BROADCAST SPECIFICATIONS

Type(channel)	Item	Default settings
iBeacon (on)	UUID Major Minor Measured power	7777772E-6B6B-6D63-6E2E-636F6D000001 Major and Minor combination is unique. -59dBm(0xC5)
KSensor (off)	Battery level Temperature Acceleration X/Y/Z	Not broadcast by default
UID (off)	Instance ID Namespace ID Measured power	Not broadcast by default
URL (off)	URL Measured power	Not broadcast by default
TLM (off)	Battery mV Boot time Temperature PDU packets	Not broadcast by default
System[1]	MAC address Model ID Battery percent Software version	Assigned at factory 102 0 ~ 100 6.x
Connectable mode[2]	Connectable or not	YES

* [1] The default setting is that when the device button is pressed, the device will start a 30-second System broadcast.

* [2] If the device is set to non-connectable mode, the device will enter the connectable mode and broadcast system advertisement for 30 seconds after pressing the button.

COMPATIBILITY

Supported iOS 8.0+ and Android 4.3+ OS system, and other BLE 4.x/5.0 compatible devices.

BASIC OPERATION

Power on/off: The product is powered off and shipped by default, press the button for more than 3 seconds will turn on the device while the LED will flash for 30 seconds. To prevent the device from being maliciously shut down, the shutdown operation can be done by clicking "power off" in the APP interface.

1. Hanger installation

Choose a solid surface, such as a wall, to ensure the installation location is sturdy and not easily loosened.

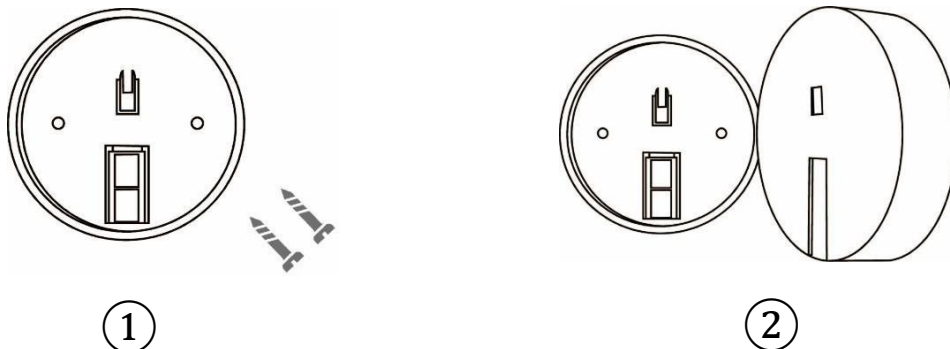

Install screws and secure the mounting bracket. Please note the installation direction as the photo is shown.

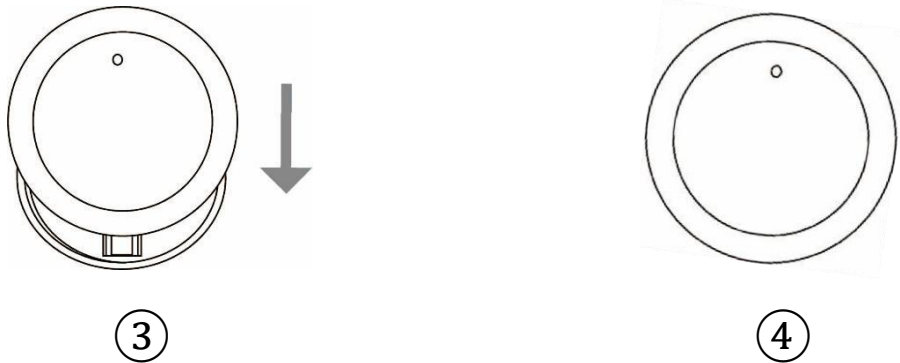

Push the beacon from the top, and hear a "click" sound, and the beacon is locked to the mounting bracket.

2. Double-sided Tape

- Keep the P2 adhesive part dry
- The double-sided adhesive first sticks to the surface of the adhesive object P2, and massage the double-sided adhesive back and forth, so the double-sided adhesive force is uniform.
- Tear off the paper on the surface layer of the double-sided adhesive on P2.
- Adhere P2 to the object and hold it for 30 seconds.

PRECAUTIONS

- Selection of installation location: Choosing a suitable location can ensure the beacon gets the best signal coverage and accuracy. Before installation, factors such as the usage scenario of the beacon, the number of devices, and environmental factors need to be considered to select the best installation location.
- Determination of installation height: Install at the best height that can cover the target area. If it is installed too high or too low, it may affect the accuracy and range of the signal.
- Avoid extreme temperatures: Avoid exposing the battery to extreme temperatures, as high temperatures can reduce battery capacity and low temperatures can affect the battery's performance.

QUALITY ASSURANCE

We have qualified for ISO9001 quality system certification. The products have been implemented by hardware test (component test, optical inspection, PCBA signal test, high and low-temperature test, drop test, Bluetooth signal test, power consumption test, etc), software test (function test, IT and ST test, etc), finish product test (button test, LED flashing test, buzzer test, etc)

Contact us: sales@gaotek.com