



Product Name	GAOTek Portable Healthcare Smart Watch
Product SKU	GAOTek-HI-143
Product URL	https://gaotek.com/product/gaotek-portable-healthcare-smart-watch/

Contact us: sales@gaotek.com

Based in New York City & Toronto, GAO Tek Inc. is ranked as one of the top 10 global B2B technology suppliers. GAO ships overnight within the U.S. & Canada & provides top-notch support thanks to its 4 decades of experience.



Contents

1. Specifications 3

2. Features 5

3. Preparation before Using 6

4. Main Functions 6

5. Safety Warning..... 6

6. Product Details..... 7

7. Main Parameters 8

8. How to Use the Main Button 9

9. SIM Card Operation Guide..... 9

10. App Installation..... 10

11. 2 – Way Call..... 12

12. SOS Call..... 13

13. GPS Positioning 14

14. Pedometer 15

15. Blood Pressure / Heart Rate Test 16

14. Voice Chat 17

15. Security Fence..... 18

16. Trajectory History 19

17. Other functions..... 20



GAOTek Portable Healthcare Smart Watch

1. Specifications

Product dimension	43 x 43 x 12.8mm
Net weight	45g
Shell material	PC + ABS
Waterproof level	IP66 / IP67 with embedded SIM
Screen display	1.28-inch TFT, 240x240 pixels
Touch screen	Support, 2.5D curved glass
Button	One SOS key, one power key
Speaker	0916 stereo monomer
Battery capacity	3.8V/650mAh, rechargeable
Charging port	Magnetic 2 pin
Charging voltage	5V / 1A
Standby time	2~5 days
Surface treatment	Spray colour + high light UV
CPU	SC8910FF (BLE 5.0 optional)
DDR	32MB + 16MB
GPS chip	MTK3336
WIFI chip	SC8910FF
Heart rate sensor	PAH8009 (sensor module)
Temperature sensor	NST117
Bluetooth module	RTL8762CK(F)
Bluetooth version	BLE 5.0 (Optional, connect to medical device or indoor location)
Operation system	Thread X (RTOS)
Frequency band	900/1800 for GSM; B1/B3/B7/B8/B38/B39/B40/B41 for 4G network
Position method	GPS +LBS + WIFI + G-Sensor + AGPS + Beidou
Antenna	LDS external laser curved
3D accelerator	DA217
Motor	Yes
SIM card	Nano, compatible with e-sim
Charge port	Magnetic 2 pin, with micro data cable



Operating temperature	-4°F to +176°F (Storage temperature -22°F to + 176°F)
Voice chat	Support 15 s/pc
Healthcare features	Heart rate, blood pressure, pedometer, sleep monitor for HI-143; Blood oxygen, HRV, temperature monitor for HI-143
Reminders	SOS call, Geo-fencing enter and exit perimeter alerts
Calculator	Support
Setting	Support UI subject change from setting
SOS message	Support
GPS tracking	Support
Reject strange calls	Support
Alarm reminder	Support
Geofencing	Support
History trajectory	Support
Reset to factory default	Support
Package size (L x W x H)	257x73x68mm
Carton size	22x41x39cm / 50pcs
Carton gross weight	8.5kg

2. Features

Multiple Features



GPS & Wifi



SOS calls



Phone calls



Messages



Heart rate



Blood pressure



Blood Oxygen



Temperature



Notifications



Safe zone



Alarms



Step counter



3. Preparation before Using

In order to better use the watch, please read the following instructions carefully and operate the watch accordingly.

- Please check if the model number is correct and if accessories are complete or not.
- Please choose a SIM card which supports GSM/LTE and power off the watch before installing it.
- Please make sure that the SIM card is activated, has data traffic and caller ID function.
- You need a smart phone to install mobile App.

4. Main Functions

This GPS Positioning Watch Phone integrates GPS module, GSM data transmission module, audio parts, and physiological indicator sensors into one. It can do GPS positioning, heart rate & blood pressure test, phone call, task assignment, attendance management, personal emergency help, personal health characteristics and statistics, communicate with backend server. It's widely used in environmental sanitation, urban management, tourism, pension, medical and elderly care industries.

The main functions of this watch are:

1. Precise localization: guardian can obtain the wearer's accurate location at any moment.
2. Emergency calling: users can call for help by pressing SOS button in case of emergency.
3. Fitness tracking: it can test heart rate, blood pressure, blood oxygen, body temperature, and steps.
4. Bi-directional calling: wearer can call his/her guardian / friends at any time, and vice versa.

5. Safety Warning

- Use only the original accessories recommended by the manufacturer.
- Do not attempt to repair it yourself. The modification of the product will affect its security.



- Avoid using the watch in the following environment: places with excessive temperature fluctuations, places with the temperature higher than 60°C or lower than 0°C, places with high pressure, dust or electrostatic interference.
- Avoid touching with corrosive cleaning agents and chemicals. Please use a soft, dry cloth to clean the watch.
- It is prohibited to use the watch at the gas stations, restricted chemical plants or near the oil depots, for the use of the watch in the above environment may raise the risk of explosion.
- When you are travelling on the airplane, please place the watch in the baggage, and try not to place it in the handbag while going through the checkpoint. The manufacturer is not responsible for the damage caused by such radiation.

6. Product Details



Mic: Do not cover it when calling

Horn: Listen to call

Red-key: SOS button. Press the button for 3 seconds to dial out an emergency number in case of emergency.

Black-key: Long-press it will power on/ power off; press once will back to main clock.

Magnetic charging pin: Connect the watch with power input to charge it.

Heart rate sensor: To detect heart rate and blood pressure.

Sim card: The place to insert a nano SIM card



7. Main Parameters

Product name: Healthcare Smart Watch

CPU: SC8910

WIFI chip: SC8910

GPS chip: MTK3336

Sensor module: PAH8009

Sensor Hub: No

3D Accelerator: DA217

DDR: 32M+16M

Support system: Thread X

SIM card: Nano SIM card

Motor: Yes

Shell material: PC + ABS

Charging port: Magnet 2 pin

Speaker: 0915 stereo speaker

Screen Display: 1.3-inch TFT, 240*240 pixels

Battery: 650mAh

Dimension: 43x12.8mm

8. How to Use the Main Button

Power on: Long press the main button to power on the device.

Power off: Press the main button in standby mode to enter into power off interface, and then long press the main button to power it off.

Voice chat: In standby mode, press the main button twice to enter into voice chat interface, then long press the main button to record chat message.

SOS: Long press the main key for SOS calling, the device will call preset SOS numbers one by one.

Heart rate/blood press: Press the main button once in standby mode to enter into heart rate/blood pressure function.

Dial: Press the main button three times to enter into phonebook, and then press the main button again to find the right contact, long press to confirm the call.

9. SIM Card Operation Guide

Plug-in SIM card: Open the rear cover of the watch and place SIM card into the slot as per the direction shown in the slot and find the golden contact, finally put on the rear cover. Please make sure that the device is off when installing SIM card. After plugged-in SIM card, wait for one minute to see if the GSM/LTE.

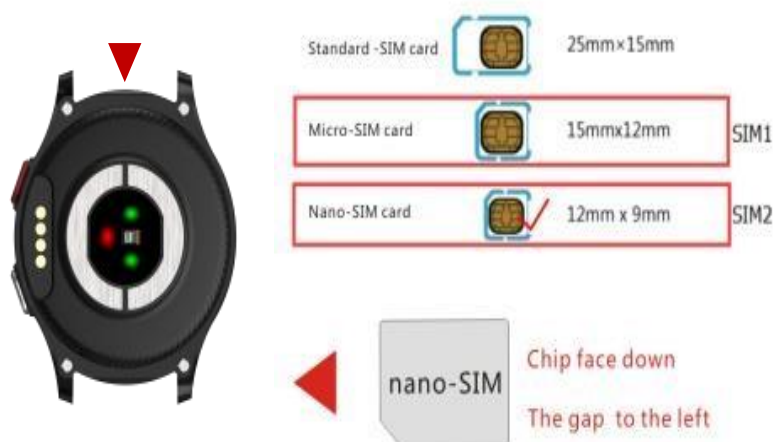

Please check: Signal is shown on the display screen.



1. If the device time is synchronized with the current time.
2. If you can call the watch with your phone. If any problem, please contact your local dealer for troubleshooting.

10. App Installation

After the watch is activated with SIM card, please install the watch APP on your mobile phone before using the watch.

- 1) Scan below QR code, or search “ai care” on Google Play or iOS store to download the watch APP.



- 2) After App installation, please create a new account and enter basic information like user name, password, mail box, etc. when prompted, and then you'll get into the sign in interface to enter the phone number and password that you have entered while registering, and finally press “sign in” to enter.

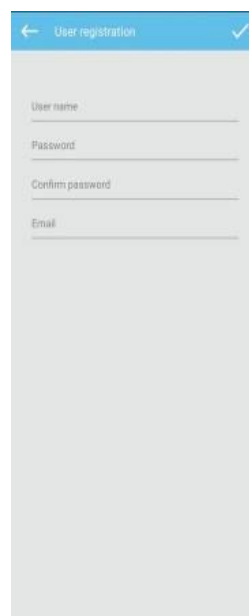
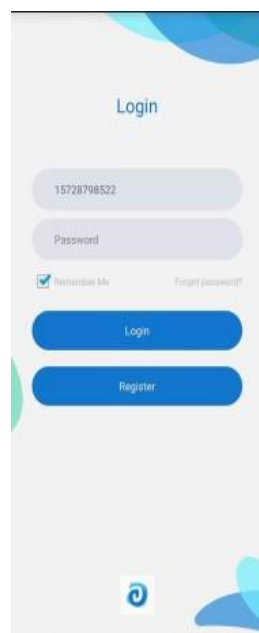

3) If it's the first time you login the account, you will be requested to bind the watch and the App with the device's IMEI code.

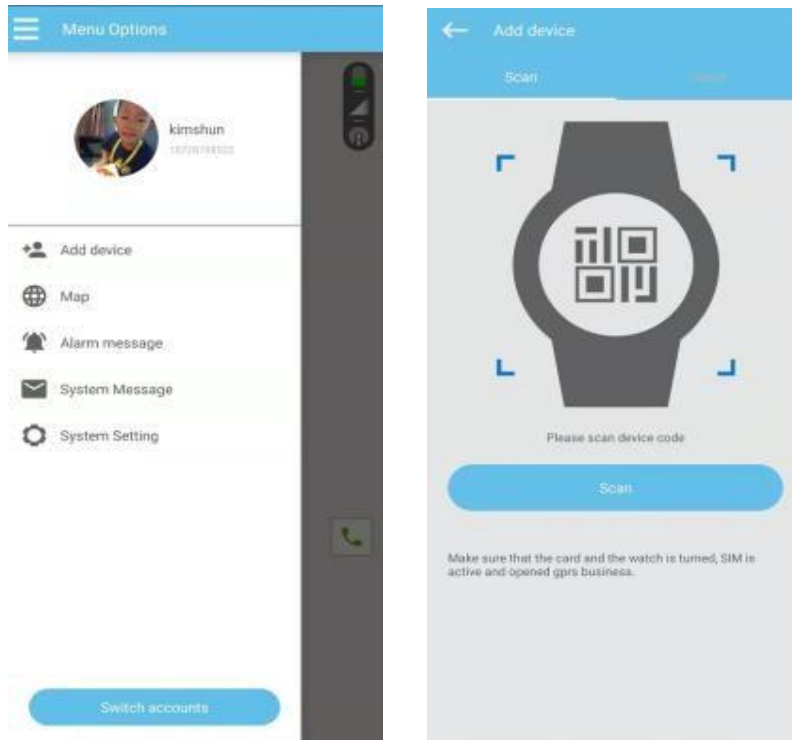

4) Financial Performance and Projections: Analyze the company's historical financial performance, including revenue, profitability, margins, growth rates, and any key financial metrics. Also, discuss the company's future growth prospects and revenue projections.



11.2 – Way Call



Enter into Watch Setting on the front page of the App, you could add contact phone number in the watch's phone book.

In the app, you can set 20 friends' numbers.

You can use the App to make voice chat with the device also.



12. SOS Call

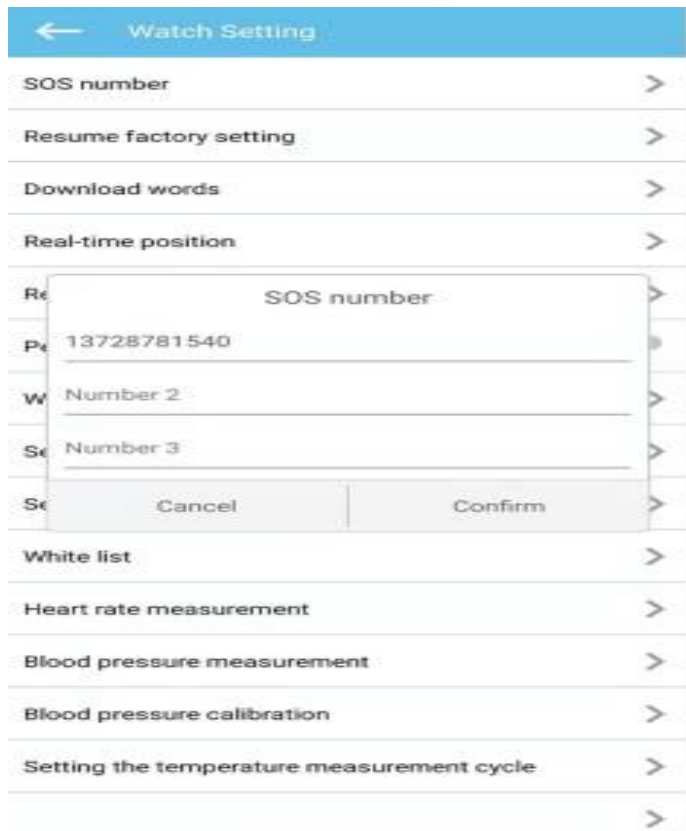

App main page – More – Watch -Setting – SOS Number, input maximum 3 numbers and confirm setting to synchronize to the watch. Press the watch main button over 3 seconds, it will call the SOS numbers and push information to the backend server.

The device can only call the emergency numbers and friends number that you have set in the app.



13. GPS Positioning

On the App “Home Page”, press “Location” to enter into sitemap and check device location. There are 3 types of working modes:



1. Default mode, the watch opens WIFI + LBS, sends position to server every 15 minutes.
2. Emergency mode, the watch opens GPS + WIFI + LBS, sends position to server every minute.
3. Energy saving mode, the watch opens WIFI + LBS, sends position to server every 60 minutes.

Note: There might be position deviation or App update failure due to signal weakness sometimes.

14. Pedometer

On the main page of the watch, the 5 digits number between signal and battery capacity bar is the step number. It is cleared every day at 0:00. You can also check more detailed sports information such as steps, distance, calorie, etc. in App.



15. Blood Pressure / Heart Rate Test



There are 3 ways to test blood pressure and heart rate:

- 1) Every 7:00 am and 7:00 pm, the device automatically tests wearer's blood pressure and heart rate, and store the result automatically.
- 2) Test from the device side, and the test result will be uploaded to the server.
- 3) Set test blood pressure and heart rate command from App setting menu.

The main reason for blood pressure/heart rate test failure is:

- 1) Not calibrated or unsuccessful calibration of blood pressure.
- 2) You need to keep quite when you do the test.

14. Voice Chat



You can send voice chat from the App to the device.

Or, send voice message from the device to App:

Press the main button to enter into voice chat interface.

Long press the main button, when you see recording symbol, start voice recording, and then press the main button again to send out the voice message.

15. Security Fence

In Electronic Fence interface, you can set security fence area. Choose its size, and also delete a security fence which you have set previously.

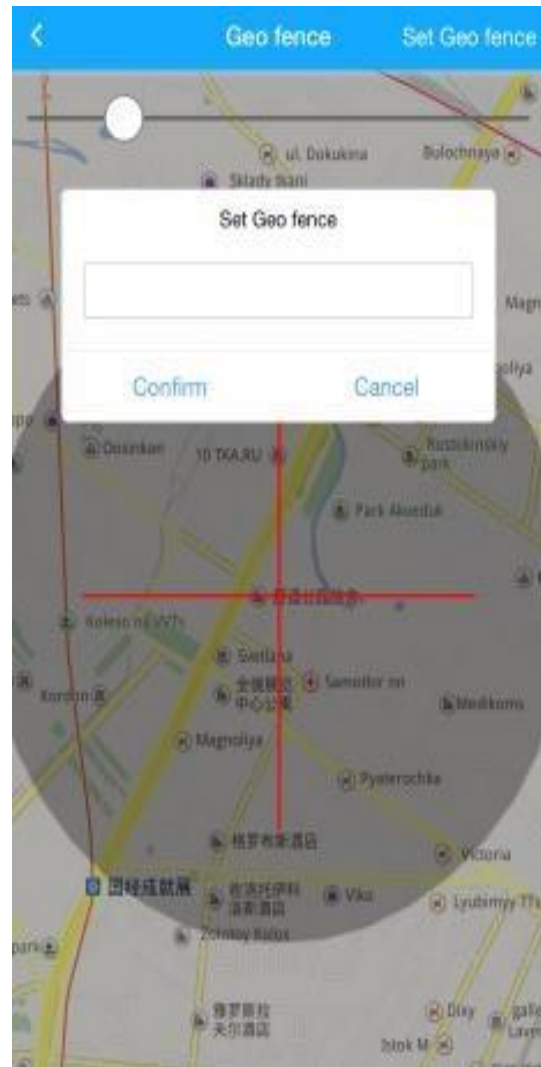
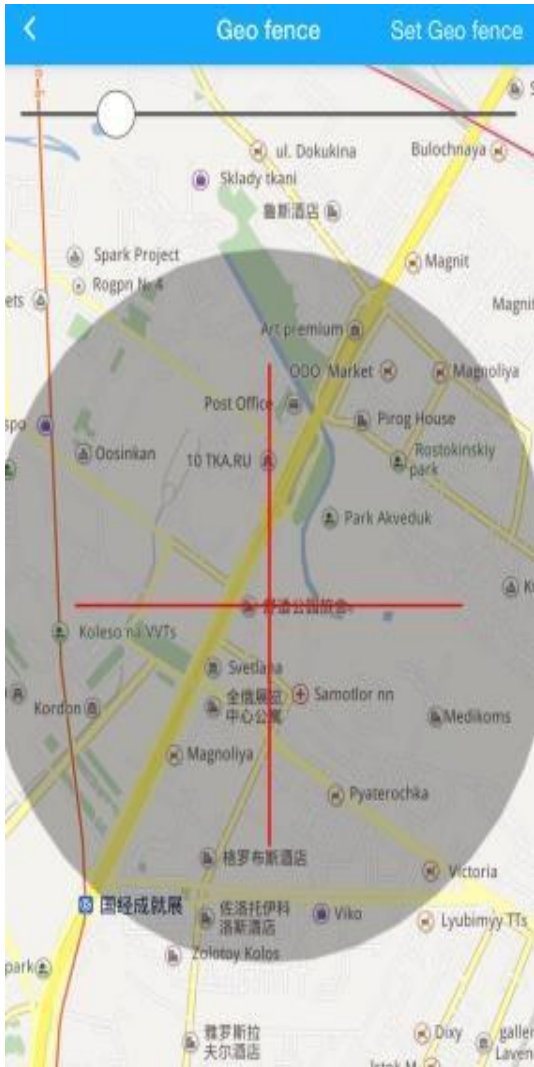

16. Trajectory History

In Historical Playback interface, you can check the latest trajectory history, with or without LBS/WIFI upon your choice.

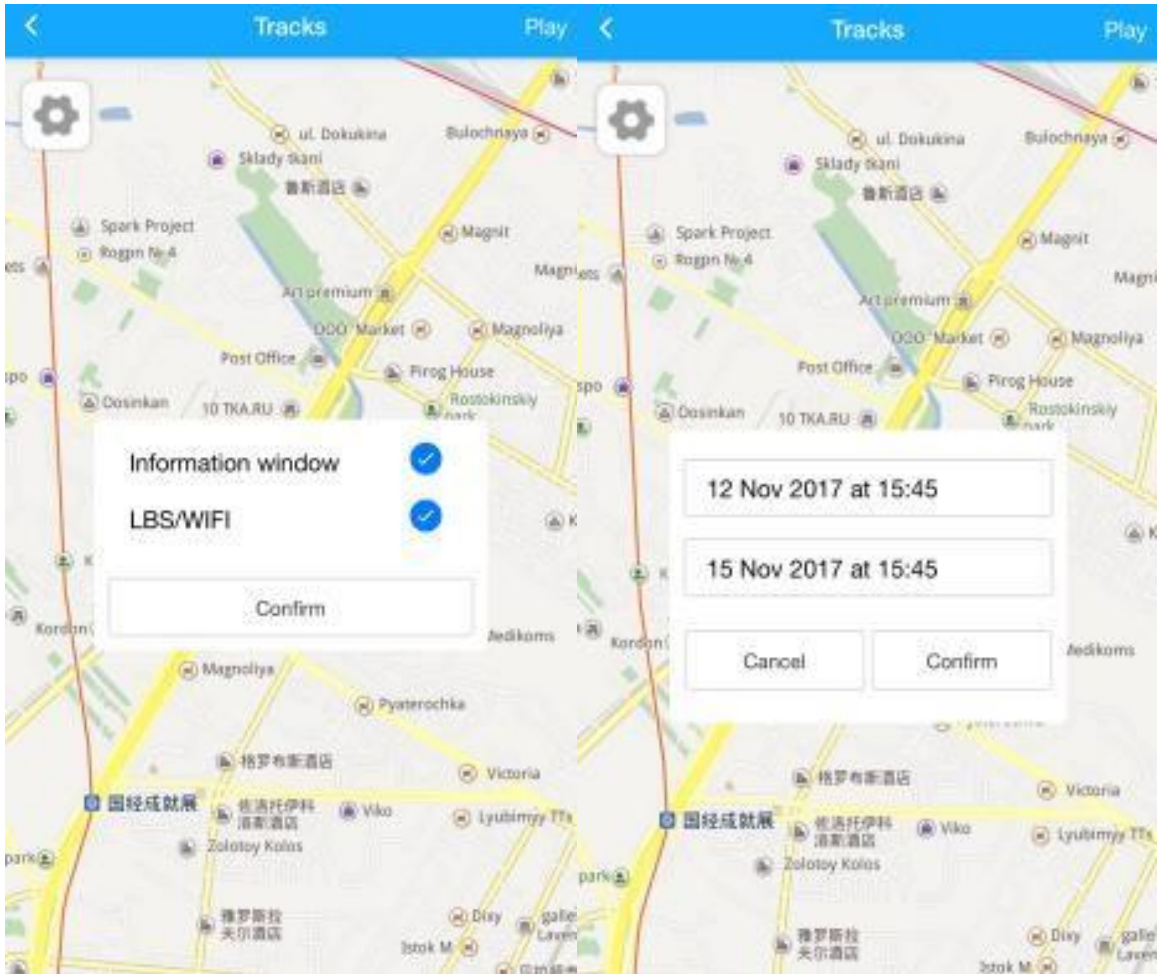



17. Other functions



There are other functions like electronic fence, history trajectory, watch setting, alert message, guardian list, step threshold setting, heart rate threshold setting, and blood pressure threshold setting.

There will be continuous upgrades and updates to this product, thus the content will be different with the final operating steps which are subject to change without prior notice.

The illustrations in the User's Guide are only for your reference.

The manufacturer reserves the right of final explanation of the User's Guide.