



<b>Product Name</b>	<b>GAOTek Flying Mini Long-Range Remote-Control Selfie Photography Camera Drone</b>
<b>Product SKU</b>	<b>GAOTek-CD-152</b>
<b>Product URL</b>	<a href="https://gaotek.com/product/gaotek-flying-mini-long-range-remote-control-selfie-photography-camera-drone/">https://gaotek.com/product/gaotek-flying-mini-long-range-remote-control-selfie-photography-camera-drone/</a>

**Contact us: [sales@gaotek.com](mailto:sales@gaotek.com)**

Based in New York City & Toronto, GAO Tek Inc. is ranked as one of the top 10 global B2B technology suppliers. GAO ships overnight within the U.S. & Canada & provides top-notch support thanks to its 4 decades of experience.



## Contents

<b>1. Safety Measures:</b> .....	3
<b>2. Protection Measures:</b> .....	3
<b>3. Drone:</b> .....	4
<b>3.1: Description:</b> .....	4
<b>4. Installing the Propellers:</b> .....	4
<b>5. Battery Charging Steps:</b> .....	5
<b>5.1: Installing Remote Control Battery:</b> .....	6
<b>6. Remote Control:</b> .....	7
<b>7. Preparing for Flight:</b> .....	7
<b>8. First Using and Return:</b> .....	9
<b>9. Basic operations:</b> .....	10



## 1. Safety Measures:

- please keep the parts of drone out of the reach of children.
- this drone is very powerful. When using it for the first time, you should push the left control lever slowly to prevent the drone from rising too fast and causing unnecessary collisions and injuries.
- when a flight is ended, please turn off the power switch of the remote control first and turn off the power switch of the drone.
- do not place the drone battery in high-temperature conditions or near flammable or explosive materials.
- please keep the drone at a distance of 4.5 meters from humans and animals to ensure safety and prevent injury.
- this drone is suitable for people aged 14 and over, and it should be within the sight of the operator (coach) to ensure safe flight.
- do not charge the battery of the remote control if the battery is a non-rechargeable battery. The drone must be used with the original batteries.
- if the drone will not be used for a long time, please take the batteries out of the remote-control unit.
- do not cause a short circuit during the charging.
- if you do not use the drone for more than 10 days, please discharge the battery of the drone to 40-50% (light for a certain time). In this way, the life of the battery will be extended greatly.
- please keep a safe distance from the rotating propeller to prevent injury.
- all operators should abide by the electromagnetic environment regulations of China on the aeronautical radio (station), which remote control radios are prohibited from being used within 500 meters of the airport pavement, they are also required to comply with the certificate and broadcasting regulations made by the relevant regulatory authorities, including flight time and area.
- please assemble the drone under the supervision of an adult.
- operators are responsible for their safe flight and safe distance. Do not hover and fly over the crowd (more than 12 people)

## 2. Protection Measures:

### 2.1. Signal breakage protection

Signal breakage protection means that after the aircraft loses the remote-control signal, it will automatically return to the take-off point when it successfully searches the satellite for positioning and keeps the GPS on.



Possible situation of entering signal breakage protection mode:

The remote control is suddenly powered off or turned off.

When the phone is operated, disconnect the hot spot, exit the software, shut down, etc.

The signal of the remote control or mobile phone is interfered with by other radio waves.

Due to wind force or inertia, the flight distance is beyond the control range of the remote control or WIFI signal from mobile phones.

There are obstructions between the aircraft and the remote control or mobile phone that affect the signal transmission.

## **2.2. Low power protection**

Low power protection means that the aircraft has an intelligent power calculation system, which will calculate the flight time supported by the remaining power according to the flight speed and distance of the aircraft. When the power is lower than the protection value, the aircraft will automatically return to the safe range. When the power is nearly exhausted, the aircraft will automatically return to the takeoff point and be forced to land.

## **3. Drone:**

### **3.1: Description:**

This drone has good controllability and stability. Besides supporting ordinary flight, it also has many other functions, such as GPS outdoor fixed point, real-time image transmission, information transmission, mobile phone control, photographing and video recording, gesture recognition, surround flight, track flight, follow flight, One-dick return, head-free flight mode, etc., it is also with many safety measures such as propeller blade stuck protection, low battery alarm, automatic low battery return, height, and flight fence restrictions.

## **4. Installing the Propellers:**

The Drone comes with replaceable propellers if the originals are broken or badly damaged

- When installing for the first time, please carefully distinguish the propeller type.

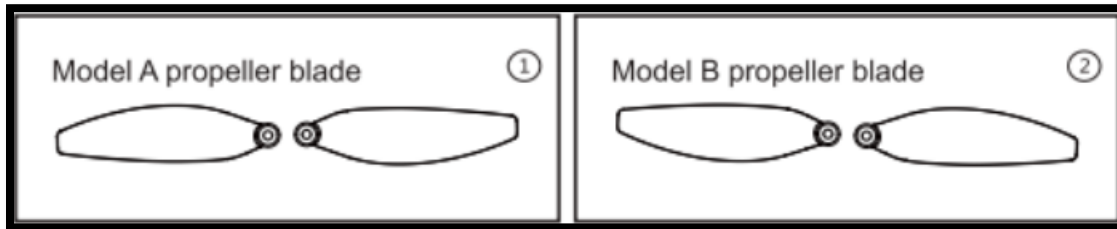

- Referring to Figure 3, insert the groove of the propeller opener into the bottom of the propeller which needs to be replaced. Press the handle of the opener to take down the propeller

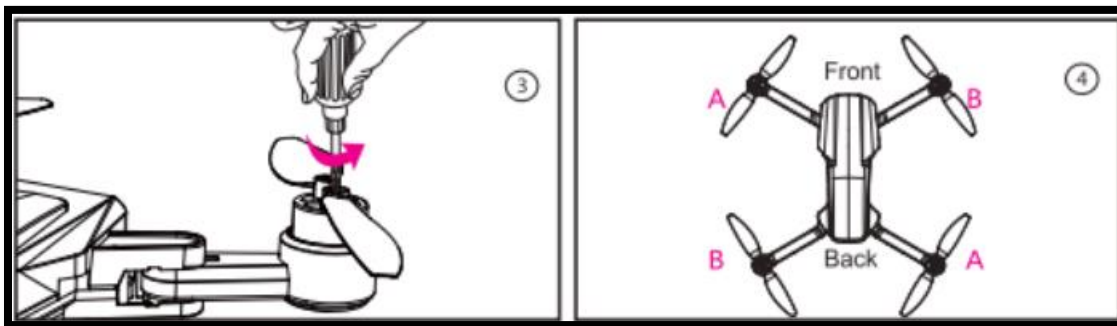

- Referring to Figure 4, distinguish between type A and type B propellers, and press the propeller vertically to install them on the motor shaft. The mark can be found on the motor. It is extremely important to use the correct propeller (A or B) for replacement. Using the incorrect propeller will make the drone out of control

## 5. Battery Charging Steps:

The battery is 7.4V lithium battery, pls using factory-configured USB cable to charge.

**⚠ First using drone to fly, please fully charge the battery.**

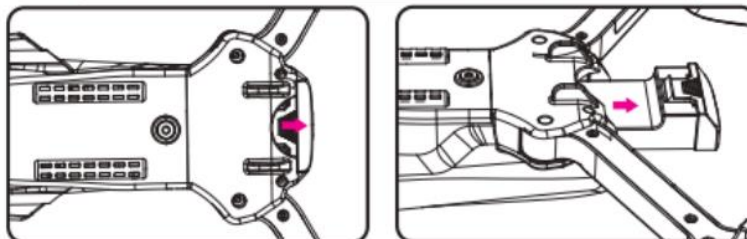

A.Rotate outward , unlock the module battery

B.upward , Remove the battery

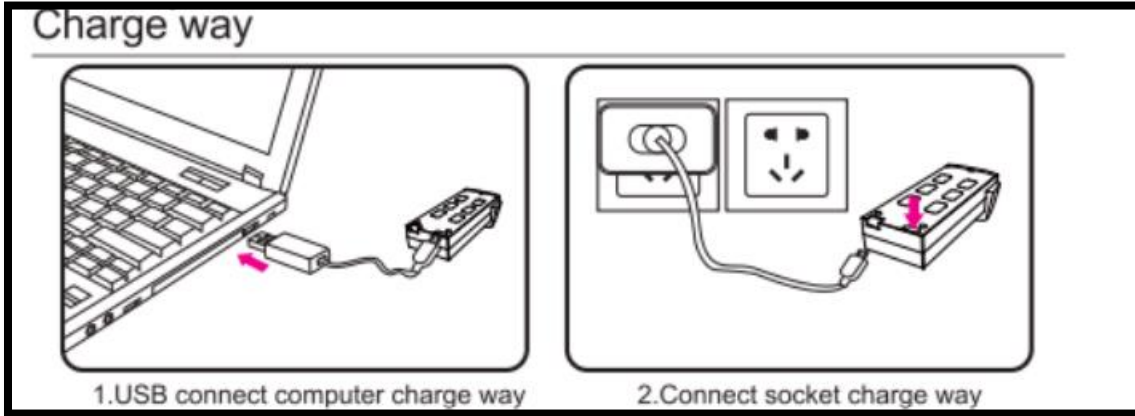

When the battery is charged, the LED of the battery is red, and the LED is green when the battery is finished charged. The charging time is about 150 minutes.

### 5.1: Installing Remote Control Battery:

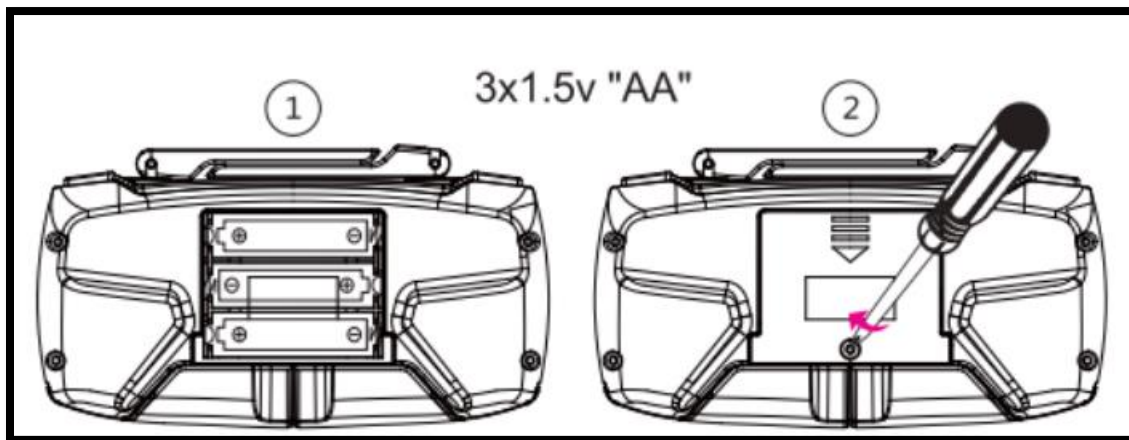

## 6. Remote Control:

### 6.1: Functions Instructions:

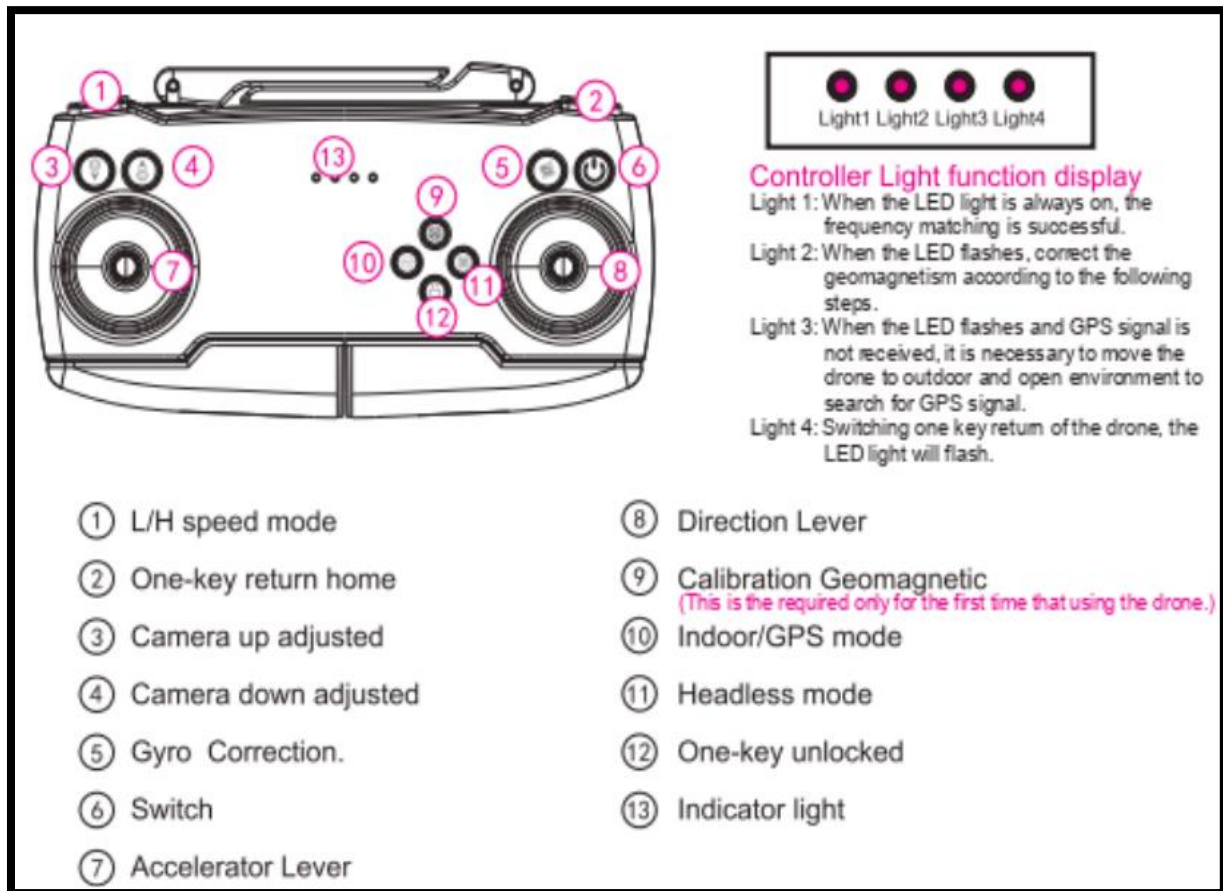

## 7. Preparing for Flight:

### 7.1: Preparing Inspection:

Please inspect the following terms before flying

- Whether the drone and remote control are both with full battery power
- Whether the propellers are installed correctly and without any damage
- Whether the propellers can run normally when the product is started

- Check whether the gyroscope and magnetometer correction were completed successfully
- Whether successfully connecting a smartphone and having a transmission image
- Whether completes the search GPS positioning
- Whether the environment is suitable for.

## 7.2: Flight Environment Requirements:









Indoor flying : please choose the open spaces that no obstacles, people and pets









Outdoor flying : Please choose sunny, windless or breezyweather.









Keep the aircraft within your sight when flying, away from obstacles, high-voltage lines, trees, etc.







Do not fly when there is strong wind, heavy rain etc weather.



### 7.3: Altitude Hold Mode:

As the GPS signal cannot be received indoors it is necessary to switch to indoor mode. (Namely of the GPS positioning) The operation is as shown below When no GPS signal is received, the indicator of the remote contra lashes quickly, switching to show flashing Tre ear gas of the crone changed from fast to slow flashing

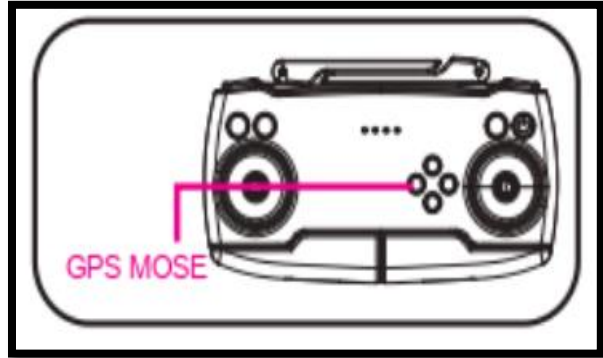

- If you turn off the GPS in an indoor environment the drone can take off but it is easy to be disturbed by indoor radio signals, which causes the drone to lose control and hit indoor persons or articles. Please use this function cautiously
- When the outdoor wind is strong, it is not recommended to open the altitude hold mode, which will cause the wind resistance ability of the drone to drop. the drone can be blown away by the wind.

### 8. First Using and Return:

When using this product for the first time, please perform a geomagnetic calibration after completing the frequency finking steps.

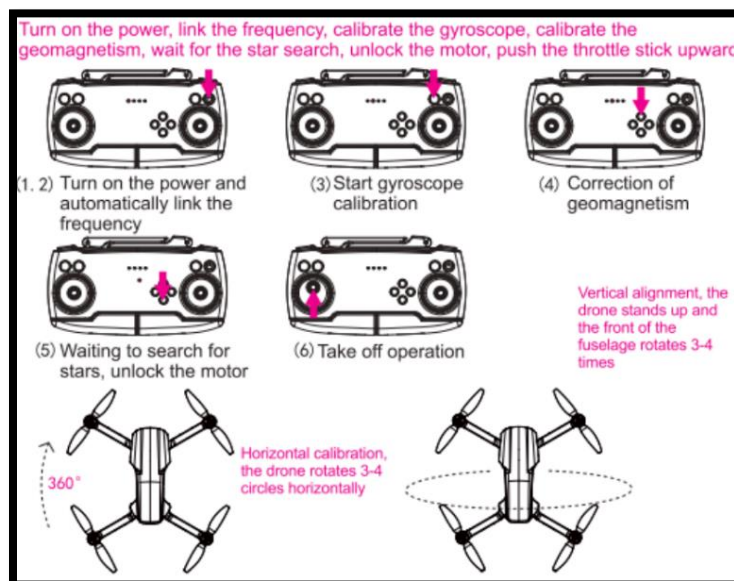





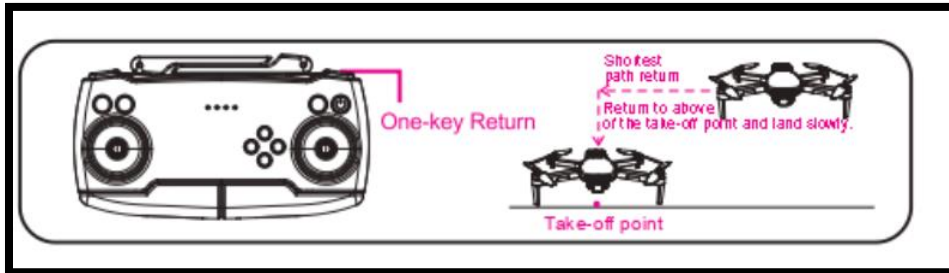

### 8.1: One-key Return:

Every time you turn on the drone, the drone will remember this take-off location and automatically press one key return button when flying, the remote control makes 2 sounds, the drone receives an operated signal, and will auto return home. Press this button again, drone will stop auto-return and keep hovering

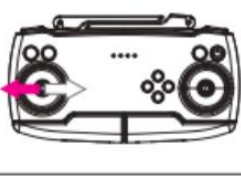

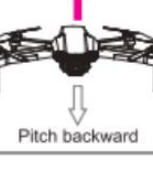
### 9. Basic operations:

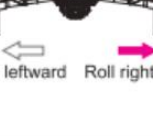
REMOTE CONTROL	DRONE	FLOW
	<p>Fly upward</p>  <p>Fly downward</p>	<p>Push left control lever forward, the drone ascends vertically. Pull left control lever rearward, the drone descends vertically.</p>
	<p>Spin clockwise</p>  <p>Spin anticlockwise</p>	<p>Push left control lever rightward, the drone spins clockwise. Push left control lever leftward, the drone spins anticlockwise.</p>
	<p>Pitch forward</p>  <p>Pitch backward</p>	<p>Push right control lever forward, the drone pitches forward. Pull right control lever rearward, the drone pitches backward.</p>
	<p>Roll leftward</p>  <p>Roll rightward</p>	<p>Push right control lever rightward, the drone rolls rightward. Push right control lever leftward, the drone rolls leftward.</p>